

High pressure blower  
**MONO<sup>6</sup> SYSTEM**



**Technical data**

Frequency	Hz	50 / 60
Air flow (20 °C)	l/min	250 – 600
Static pressure	kPa	3.6
Max. ambient temperature	°C	60
Outside diameter air outlet	mm	∅ 38
Weight with 3 m cable	kg	1.0
Conformity mark		CE (ErP n/a)
Protection class II		□

Voltage	V –	230	120
Power consumption	W	120	120
<b>Order no.</b>		<b>146.702</b>	<b>149.638</b>

**Installation dimensions in mm**

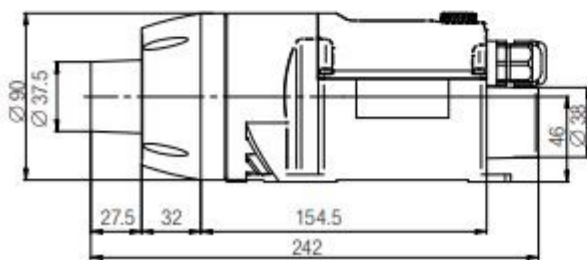
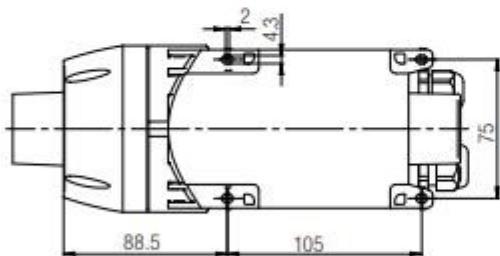

- Adjustable air volume
- Compact and efficient
- "e-drive" operating unit
- Brushless motor
- Tool protection
- System interface
- Mounting tabs

